

PLYWOOD SHEATHING

2X SOLE PLATE W. 16d
NAILS @ 12" O.C.

2X SOLID BLOCKING OR
CONTINUOUS RIM JOIST;
FOR RIM JOIST PROVIDE 2
16d NAILS INTO EACH FLOOR
SUPPORT

EDGE NAILING

FINISHED GRADE
SLOPE TO DRAIN AWAY
FROM FOUNDATION

2X STUD FRAMING

5/8" Ø X 10" LONG
ANCHOR BOLT@ 6' O.C.
W/ 3" SQUARE X 1/4"
THICK STEEL PLATE
& WASHER; PER CBC
SEC. 2306.12.8

PLYWOOD FLOOR
SHEATHING

FLOOR SUPPORTS I.E.
JOISTS, BEAMS, ETC.

MECHANICAL FASTENER

2X TREATED SILL PLATE

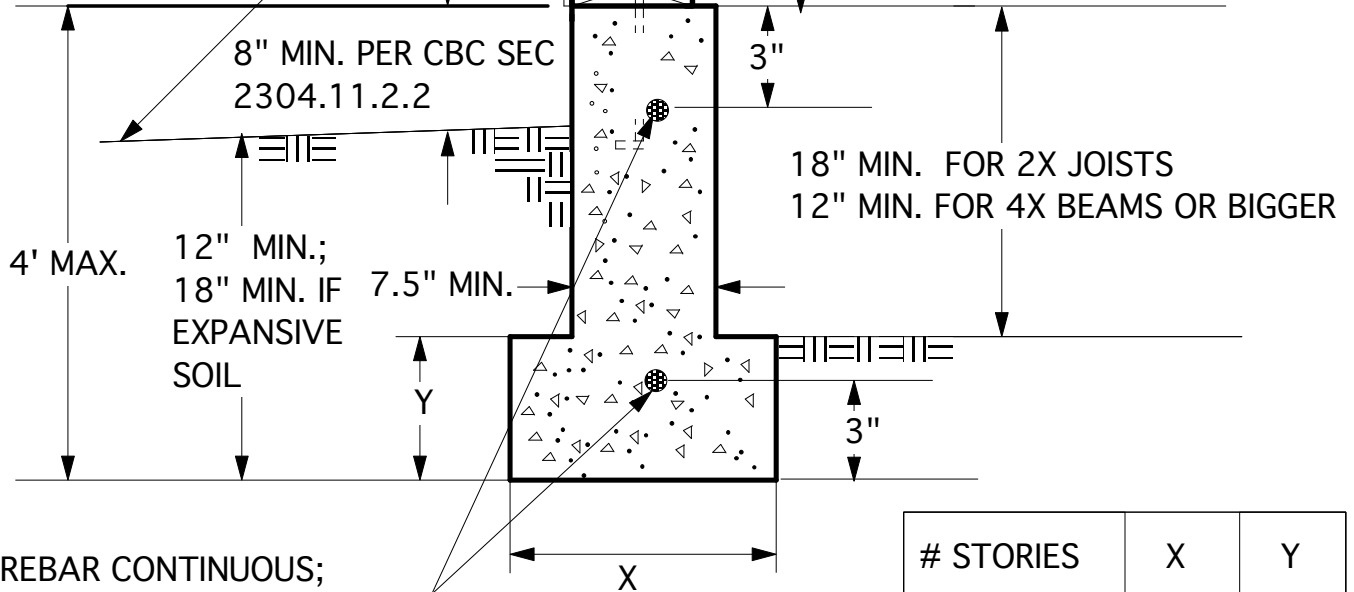

#4 REBAR CONTINUOUS;
TOP & BOTTOM;
REBAR SPACING TO BE A
MAX. 18" O.C.

# STORIES	X	Y
1	12"	6"
2	15"	6"
3	18"	8"

EXTERIOR FOOTING (RAISED FLOOR)

2007 CBC

DETAIL ##

DATE: 2/08

REVISED:

THIS DETAIL APPROVED BY:

FAIRFIELD _____	SUISUN _____	DAVIS _____
VACAVILLE _____	NAPA _____	NAPA CO. _____
DIXON _____	RIO VISTA _____	SOLANO CO. _____
BENECIA _____	VALLEJO _____	MARTINEZ _____
WINTERS _____	AM. CANYON _____	WOODLAND _____